

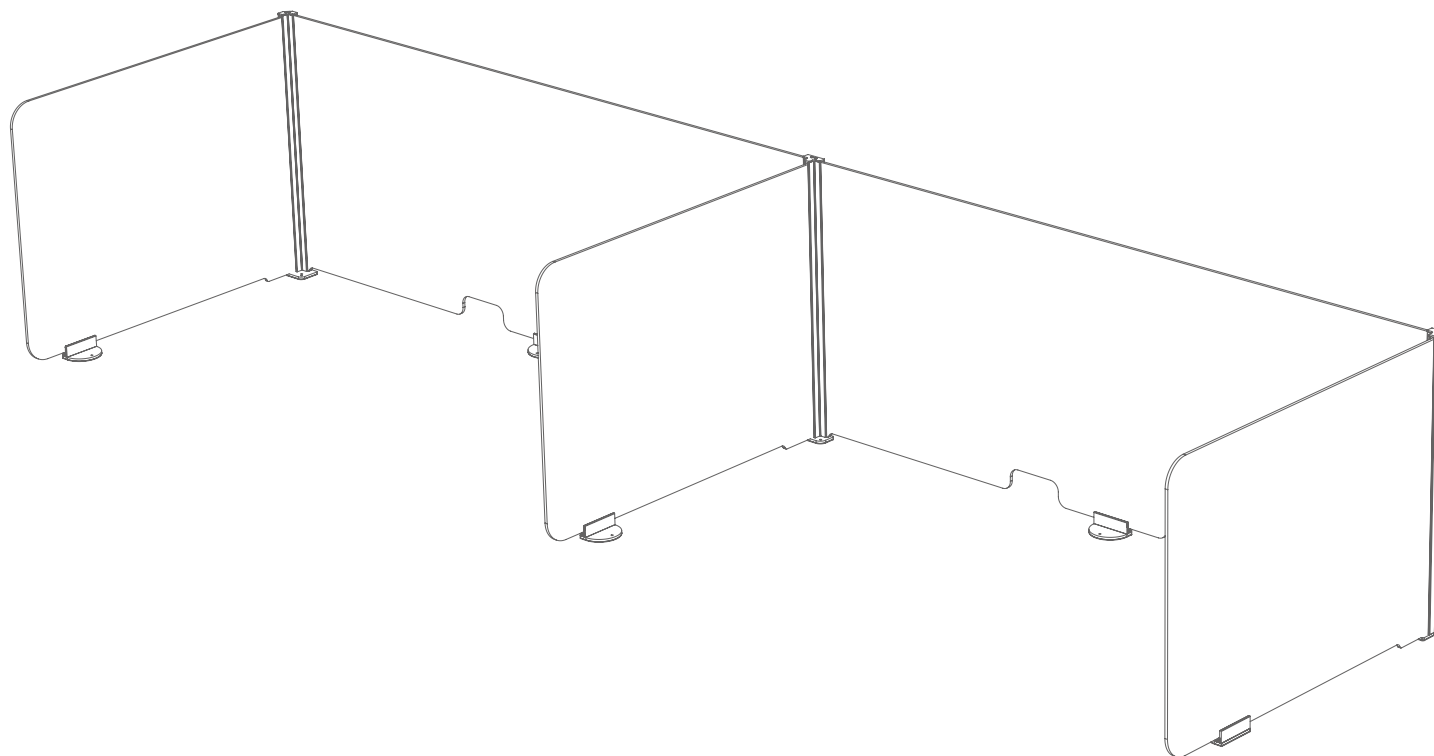

Safe-Vu Float Single

Assembly Instructions

Arrangement may vary.



Whats in the box

Parts and qty's will vary depending on order.

A - Divider Wing

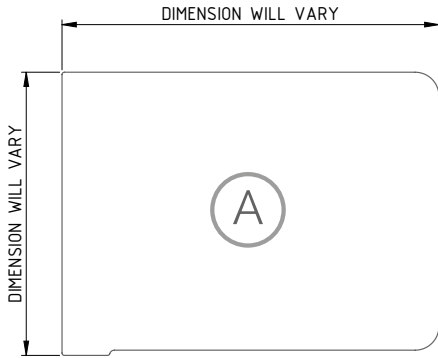

B - Divider Back Panel

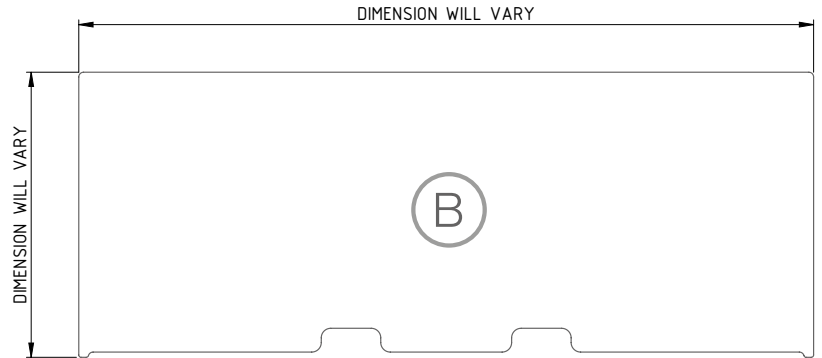

C - Support Foot

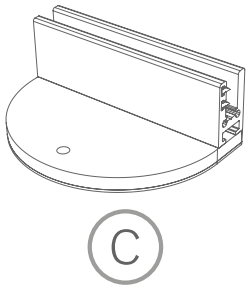

D - End Post

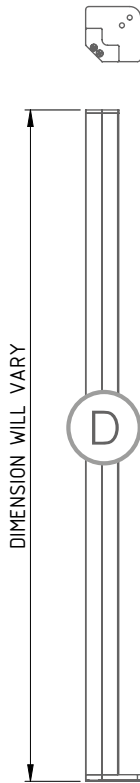

E* - Mid Post

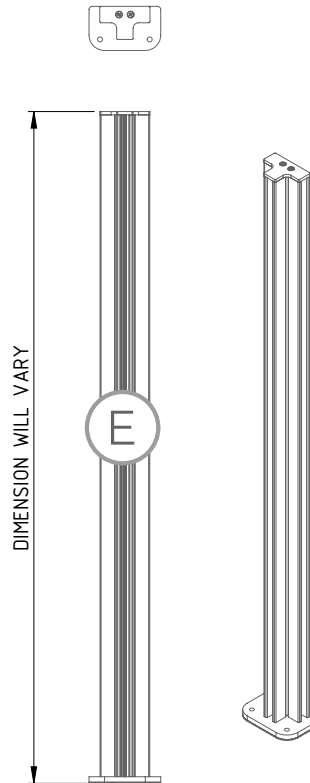

* Mid post not required for single desk solutions.

Panel installation.

profile detail may vary.

When inserting panels into ensure panel is engaged in profile along full length.

(Glass panels - handle with extra care and do not place full weight on panel corners.)

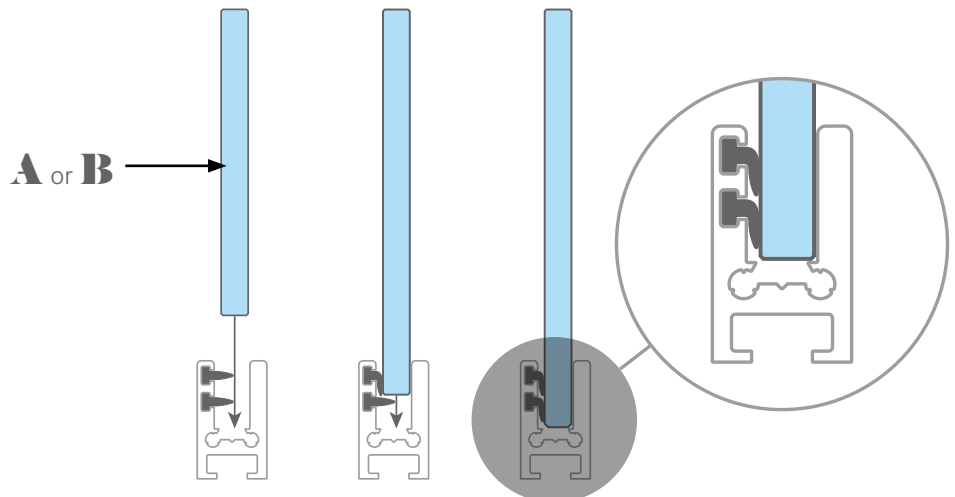

1. Support Feet Installation.

panel detail may vary.

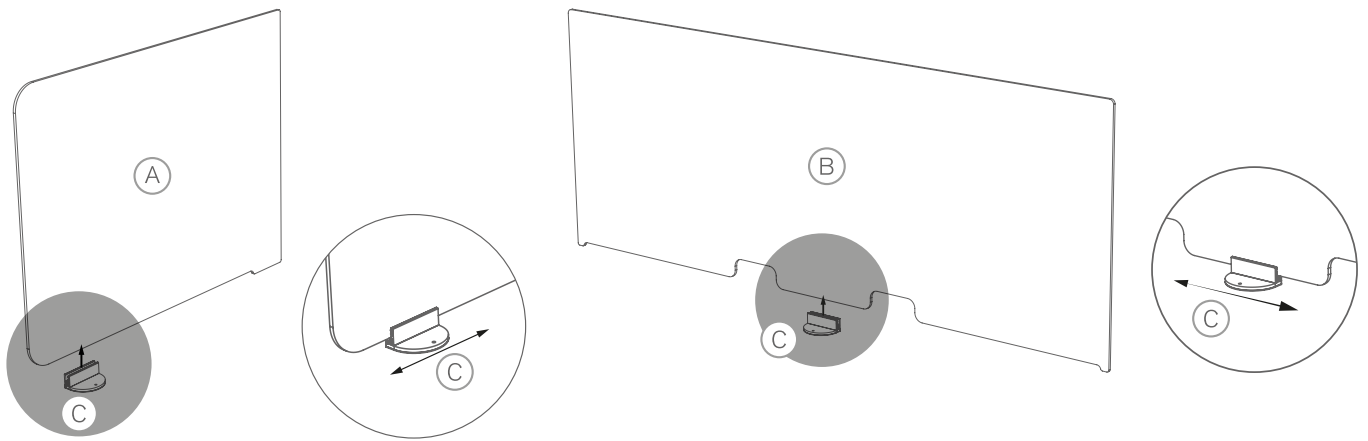

2. Starter End Post.

panel detail may vary.

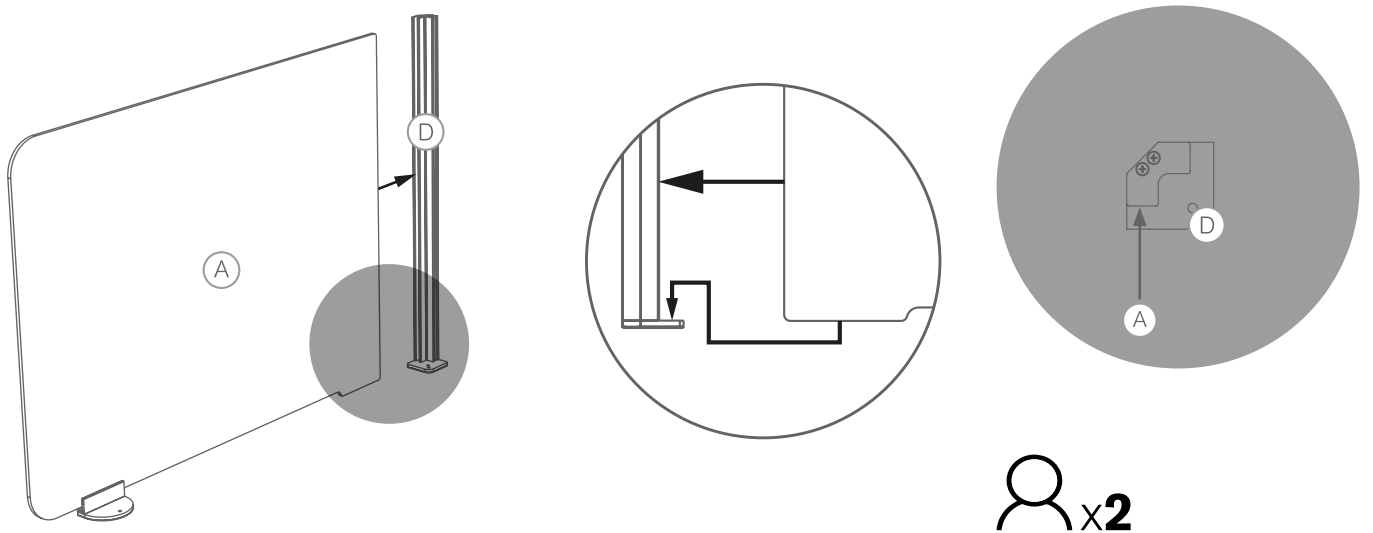

3. Back Panel.

panel detail may vary.

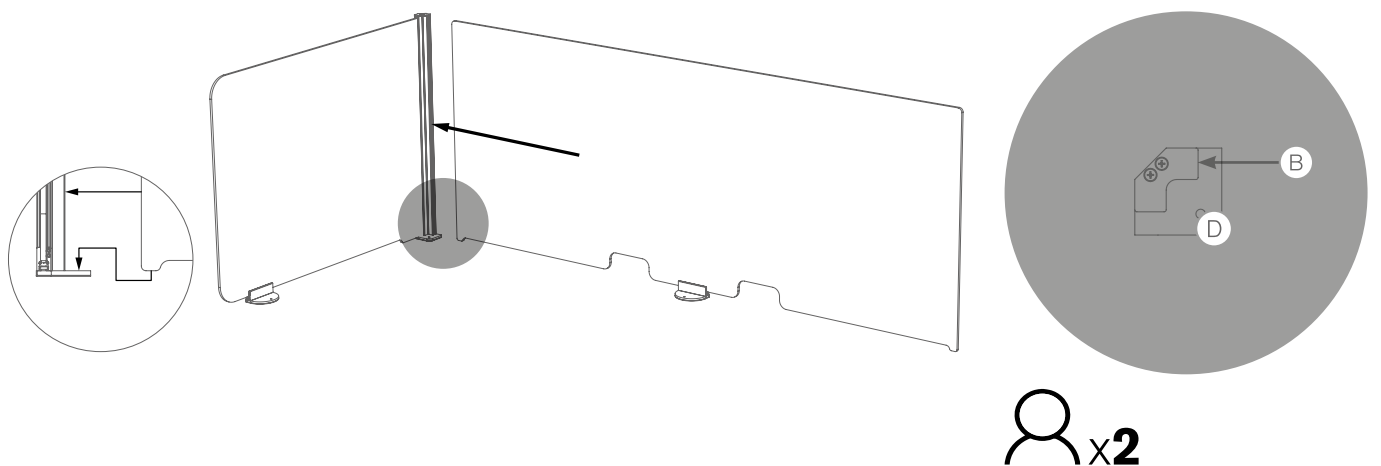

4. Mid Post*.

panel detail may vary.

* Mid post not required for single desk arrangement. See step 5 for single desk arrangement.

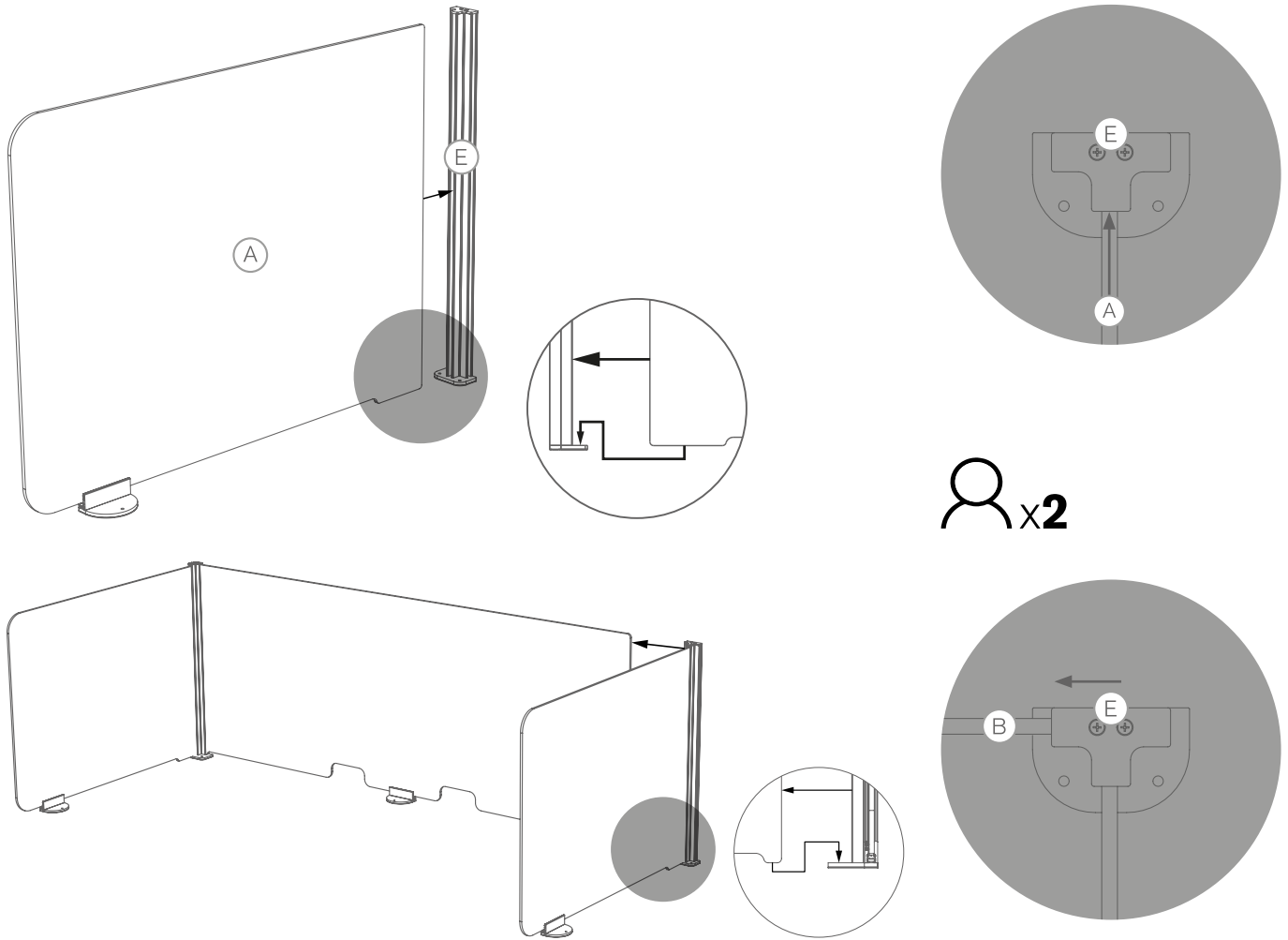

Repeat Steps 3 & 4 until end of desk run.

5. End Post.

panel detail may vary.

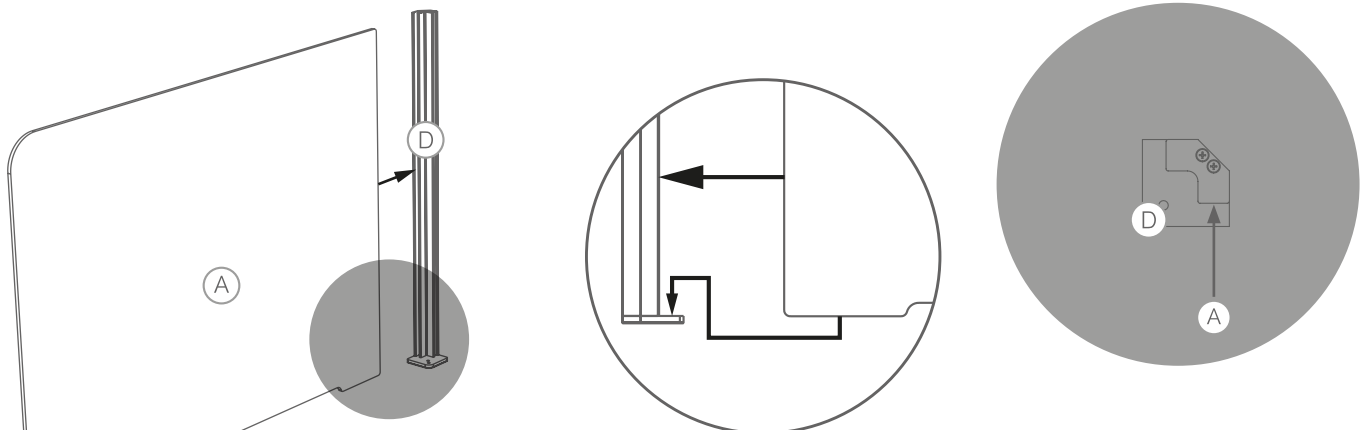

5. End Post.

panel detail may vary.

Multiple Desk Arrangement.

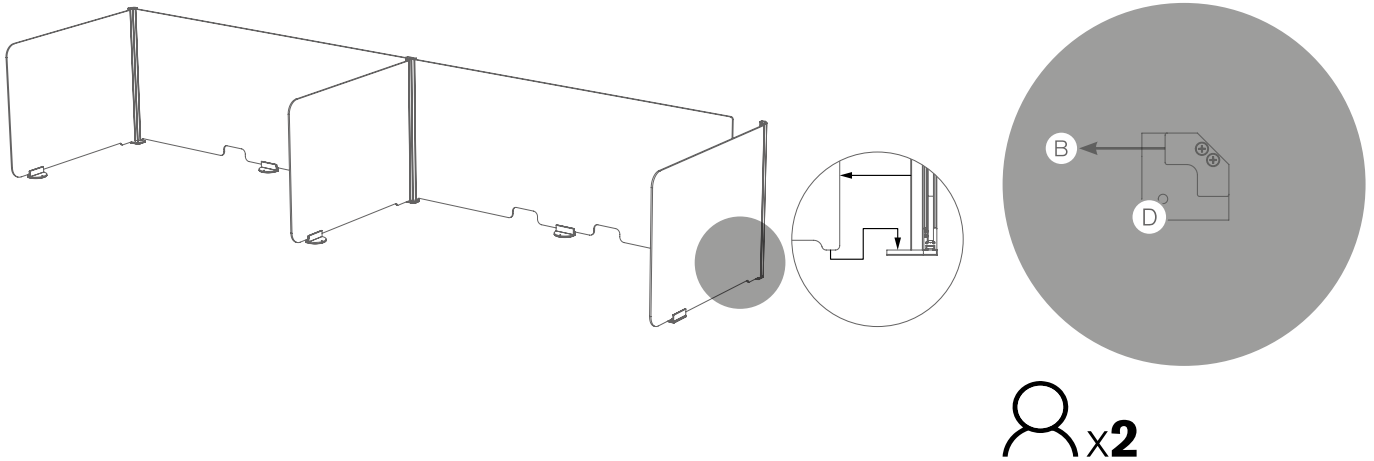

Single Desk Arrangement.

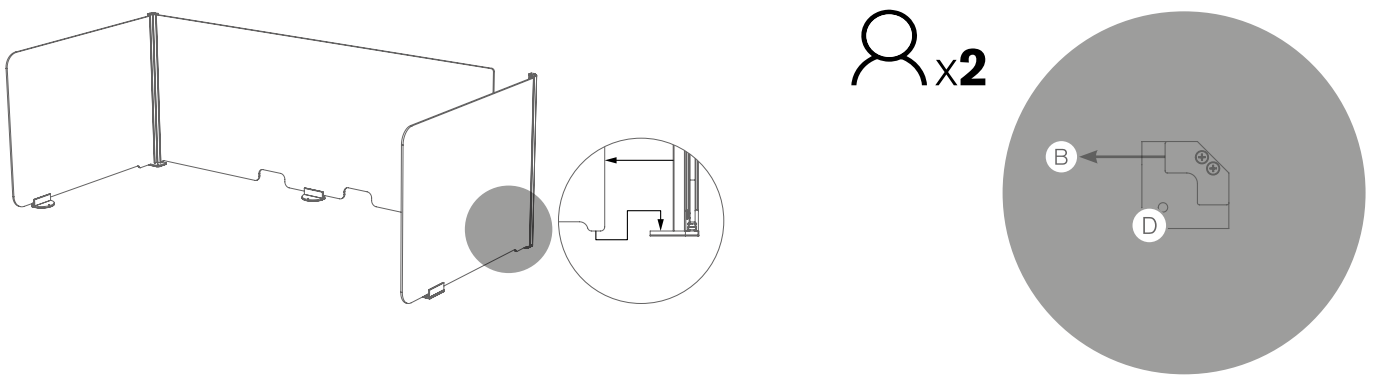

6. Finishing.

panel detail may vary.

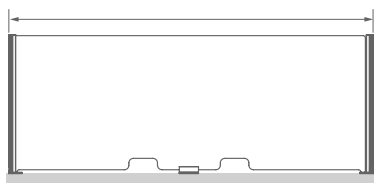

Centre assembled float divider screens on the desk/desk run.

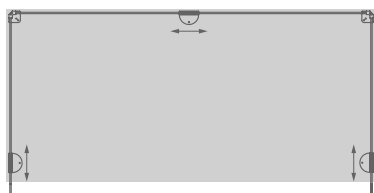

Adjust support feet on wings and back panels to avoid obstructions or to suit desk over hangs.

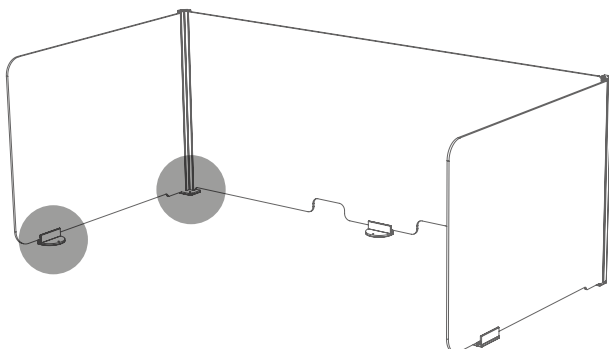

Once positioning finalised post base plates and support feet have optional fixing holes.