

# TENSA MAXI WALL RETRACTING BELT BARRIER

Wall Mounted Unit

Perfect for limiting access to areas without taking up floor space. Features 7.7m or 9m of retractable webbing. Ideal for a variety of applications.

## FEATURES & BENEFITS

- The maxi wall unit features a Tensabarrier® cassette which is encased in a black hard wearing plastic body with coloured end caps - stainless steel option available.
- An internal steel frame provides added strength and durability whilst also protecting the components inside.
- The unit can be easily installed onto a variety of surfaces to suit different applications.
- Safest barrier on the market- our cassettes have a unique braking system for slower webbing retraction.

## APPLICATIONS

- Eliminate unsafe working conditions by clearly defining routes.
- Restrict access to dangerous areas.
- Limit pedestrian access to out of service areas.
- Use to identify hazards before they cause harm.
- Ideal for a variety of applications.



**Fixing Options**  
Six options available

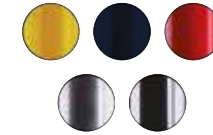

**Unit Finishes**  
Five finishes available



**Webbing Options**  
Standard Webbing  
50mm width



**Webbing Lengths**  
Two lengths available



**Webbing Designs**  
Full range of colours, designs and custom options



**Tape End Options**  
Six options available

## DIMENSIONS:

### PRODUCT SPECIFICATION

- Plastic end caps available in 4 finishes or full stainless steel body.
- Six mounting options available depending on the application: standard, clamp, warehouse rack, removable, magnetic and glass mount.
- A variety of tape end options are available: standard anti-tamper, rubber, panic break, magnetic, one way loop, and wire clip.
- Available with any Tensator® standard (50mm) webbing options.
- Tools only required for mounting the unit to desired surface. Screws are not included as this is dependent on wall type.
- Each unit comes with corresponding wall receiver clip which allows the wall unit webbing to connect to - made from Zinc for its anti-corrosive properties.

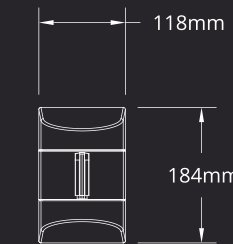

Weight 1.2kg

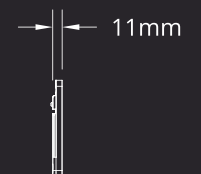
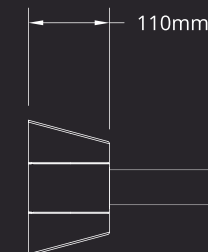
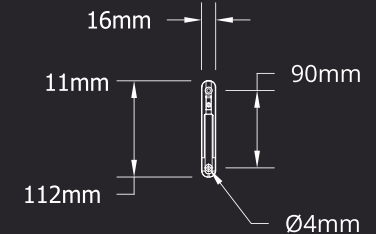

01733 511030  
sales@xl displays.co.uk